

Special Exhibition: The Crossroads of Civilization

# The Bamiyan Giant Buddhas

## Sun God and Maitreya Beliefs from Gandhara to Japan

LIST OF EXHIBITS

September 14- November 12, 2024

 Mitsui Memorial Museum

● National Treasure  
◎ Important Cultural Property

**ROOM 1**

No.	Cat.	Title	Region / Period	Owner	Display	
					9/14 ▼ 10/14	10/16 ▼ 11/12
1-1	17	Sūrya	India / 2nd-1st century BCE	Hirayama Ikuo Silk Road Museum	●	●
1-2	24	Great departure	Gandhara / 2nd-3rd century	Hanzomon Museum	●	●
1-3	20	Sūrya	Mathura / 4th-6th century	Ryukoku Museum	●	●
1-4	23	Sūrya capital of column	Gandhara / 2nd-3rd century	Hirayama Ikuo Silk Road Museum	●	●
1-5	18	Cosmetic Plate	Gandhara / 2nd century BCE-1st century CE	Hirayama Ikuo Silk Road Museum	●	●
1-6	19	Cosmetic Plate	Gandhara / 2nd century BCE-1st century CE	Hirayama Ikuo Silk Road Museum	●	●
1-7	31	Cosmetic Plate	Gandhara / 2nd century BCE-1st century CE	Hirayama Ikuo Silk Road Museum	●	●
1-8	26	First Sermon	Gandhara / 2nd-3rd century	Tokyo National Museum	●	●
1-9	27	Sun disk	Gandhara / 2nd-3rd century	Ryukoku Museum	●	●
1-10	28	Seated Buddha	Gandhara (Allegedly Swabi) / 2nd-4th century	Ryukoku Museum	●	●
1-11	13	Gold coin of Huvishka	Around Gandhara / Late 2nd century		●	●
1-12	14	Silver coin of Menander I	Afghanistan / Mid-2nd century BCE	Hirayama Ikuo Silk Road Museum	●	●
1-13	15	Silver coin of Maues	Pakistan / 1st century BCE	Hirayama Ikuo Silk Road Museum	●	●
1-14	16	Copper coin of Kanishka I	Around Gandhara / Early 2nd century	Hirayama Ikuo Silk Road Museum	●	●
1-15	35	Royalty	Gandhara / 2nd-4th century	Hirayama Ikuo Silk Road Museum	●	●
1-16	29	Wind god	Gandhara / 3rd-5th century	Hirayama Ikuo Silk Road Museum	●	●
1-17	30	Wind god (Vāyu)	Northern India / Gupta dynasty, 5th-7th century	Hirayama Ikuo Silk Road Museum	●	●

**ROOM 2**

2-1	90	◎ Seated Bodhisattva Maitreya with one leg pendent	Japan / Hakuho period, dated 666 (Tenji 5)	Yachū-ji, Osaka	●	●
-----	----	--	---	-----------------	---	---

## ROOM 3

No.	Cat.	Title	Period	Owner	Display	
					9/14 ▼ 10/14	10/16 ▼ 11/12
3-1	25	Miniature votive stūpa	Gandhara / 2nd-3rd century	Hirayama Ikuo Silk Road Museum	●	●
3-2	40	Line drawing of the wall paintings of the Bamiyan caves, by MIYAJI Akira	Japan / 1960's-70's	Kyoto University etc.	●	●
3-3	41	Research Notebooks, by MIYAJI Akira	Japan / 1960's-70's		●	●

## ROOM 4

4-1	12	Line drawing of the wall painting of the Bamiyan East Giant Buddha niche, supervised by MIYAJI Akira and illustrated by SHOGAKI Masako	Japan / 2022	Ryukoku Museum	●	●
4-2	37	Line drawing of the wall painting of the Bamiyan West Giant Buddha niche, supervised by MIYAJI Akira and illustrated by SHOGAKI Masako	Japan / 2023	Ryukoku Museum	●	●
4-3	47	Divination by Brahmin Asita	Gandhara / 2nd-3rd century	Hanzomon Museum	●	●
4-4	48	Death Robe	Swat / 1st-2nd century	Ryukoku Museum	●	●
4-5	53	Dīpaṃkara Jātaka and Bodhisattva Shakya in Tuṣita Heaven	Gandhara / 2nd-3rd century	Hanzomon Museum	●	●
4-6	55	Battle over the relics, distribution of the relics, and their transportation	Gandhara / 2nd-3rd century	Hirayama Ikuo Silk Road Museum	●	●
4-7	58	Brahmā and Indra entreating Buddha to preach	Gandhara / 2nd-3rd century	Hanzomon Museum	●	●
4-8	10	Great Tang Records on the Western Regions (Datang xiyuji)	Japan / Edo period, dated 1653 (Jōō 2)	Ryukoku University Library	●	●
4-9	2	© Portrait of Xuanzang Sanzang ( <i>Genjō Sanzō</i> )	Japan / Kamakura period (13th-14th century)	Tokyo National Museum	9/14~ 9/27	
4-10	3	Portrait of Xuanzang Sanzang ( <i>Genjō Sanzō</i> )	Japan / Kamakura period (14th century)	Tokyo National Museum		●
4-11	1	Seated Xuanzang Sanzang ( <i>Genjō Sanzō</i> )	Japan / Kamakura period (13th-14th century)	Yakushi-ji, Nara	●	●
4-12	5	Xuanzang Sanzang ( <i>Genjō Sanzō</i> ) obtaining the sūtras	China / Yuan dynasty (14th century)	Yakushi-ji, Nara	●	
4-13	6	Xuanzang Sanzang ( <i>Genjō Sanzō</i> ) and the sixteen guardian deities	Japan / Nambokuchō period (14th century)	Yakushi-ji, Nara		●
4-14	7	Xuanzang Sanzang ( <i>Genjō Sanzō</i> ) and the sixteen guardian deities	Japan / Nambokuchō period (14th century)	Daruma-ji, Nara	●	
4-15	8	Shakyamuni and the sixteen guardian deities of Prajñāpāramitā sūtra in Chinese	Japan / Kamakura period (14th century)	Yakushi-ji, Nara		●
4-16	56	Copper coin of Kanishka I	Around Gandhara / Early 2nd century	Hirayama Ikuo Silk Road Museum	●	●
4-17	57	Standing Bodhisattva Maitreya	Gandhara / 3rd-4th century		●	●
4-18	59	Bodhisattva Maitreya and Worshipers	Gandhara / 3rd-4th century	Hirayama Ikuo Silk Road Museum	●	●
4-19	60	Seated Bodhisattva Maitreya with crossed legs	Kapisi / 3rd-4th century	Hirayama Ikuo Silk Road Museum	●	●
4-20	61	Shakyamuni with the Eight Great Bodhisattvas	India / Pala dynasty, 9th century	Tokyo National Museum	●	●
4-21	68	Bodhisattva Maitreya in Tuṣita Heaven	Gandhara / 2nd-3rd century	Tokyo National Museum	●	●
4-22	69	Bodhisattva Maitreya in Tuṣita Heaven	Gandhara / 2nd-3rd century	Shitenno-ji, Osaka	●	●
4-23	70	Preaching Buddha	Gandhara / Around 3rd century	Tokyo National Museum	●	●
4-24	71	Child on a lotus flower	Gandhara / 1st-3rd century		●	●
4-25	77	Seated Bodhisattva Maitreya with crossed legs	Gandhara / 2nd-3rd century	Hirayama Ikuo Silk Road Museum	●	●
4-26	78	Seated pensive Bodhisattva Avalokiteśvara with one leg pendent	Gandhara / 3rd-4th century	Hirayama Ikuo Silk Road Museum	●	●

## ROOM 5

No.	Cat.	Title	Period	Owner	Display	
					9/14 ▼ 10/14	10/16 ▼ 11/12
5-1	79	Seated pendent Bodhisattva with one leg pendent	China / Eastern Wei dynasty, dated 544 (Wuding 2)	Taito Calligraphy Museum	●	●
5-2	80	Seated Bodhisattva Maitreya with crossed legs	China / Northern Wei dynasty, Early 6th century	Hamamatsu Municipal Museum of Art	●	●
5-3	81	Seated pensive Bodhisattva with one leg pendent	China / Northern Qi dynasty, dated 557 (Tianbao 8)	The University Art Museum, Tokyo University of the Arts	●	●
5-4	82	Seated Maitreya Buddha with attendant deities	China / Tang dynasty, dated 750 (Tianbao 9)	The University Art Museum, Tokyo University of the Arts	●	●
5-5	reference	Deity on a lotus flower	Western regions of China / 5th-7th century	Tokyo National Museum	●	●
5-6	89	Seated Bodhisattva with one leg pendent	Korean Peninsula / Three Kingdoms period (7th century)	Yase Myōden-ji, Kyoto	●	●
5-7	91	Seated Bodhisattva with one leg pendent	Korean Peninsula / Three Kingdoms period or Japan / Hakuho period (7th century)	Enryaku-ji, Shiga	●	●
5-8	114	Image of Bodhisattva Maitreya	Japan / Kamakura period (13th century)	Tokyo National Museum	9/14-9/27	
5-9	84	● Bodhisattva Maitreya, by Gao Wenjin (original picture)	China / Northern Song dynasty, published in 984 (Taipingxingguo 9)	Seiryō-ji, Kyoto	9/28-10/14	
5-10	117	Iconography in Ten Fascicles ( <i>Jikkanshō</i> ), vol.5	Japan / Edo period, dated 1702 (Genroku15)	Ryukoku University Library		●
5-11	102	◎ Iconography of the Bodhisattva Maitreya	Japan / Late Heian period (12th century)	Ninna-ji, Kyoto	●	
5-12	97	Miscellaneous Records of Classified Sacred Images ( <i>Besson zakki</i> ), vol.18	Japan / Kamakura period, dated 1321 (Genkō 1)	Shitenno-ji, Osaka		●
5-13	93	◎ Selections on spiritual communion with Buddha Maitreya ( <i>Miroku nyorai kannōshō</i> ), vol.2	Japan / Kamakura period (13th century)	Tōdai-ji, Nara	●	●
5-14	45	Madhyama Āgama in Chinese, vol.13(No.66)	China / Ming dynasty, published in 1589 (Wanli 17)	Ryukoku University Library	●	●
5-15	49	Sūtra on the Ocean-Like Samādhi of the Visualization of Buddha(Guan fo san mei hai jing)	China / Ming dynasty, published in 1589 (Wanli 17)	Ryukoku University Library	●	●
5-16	62	Guan mi le pu sa shang sheng dou shuai tian jing	Japan / Kamakura period (13th-14th century)	Kyoto National Museum	9/14-9/27	
5-17	66	Maitreyavyākaraṇa in Chinese, translated by Kumārajīva (Mi le xia sheng cheng fo jing)	Japan / Nara period, dated 730 (Tempyō 2)	Tokyo National Museum	9/28-10/14	
5-18	52	Saddharmapuṇḍarīka Sūtra in Chinese, vol.7 (translated by Kumārajīva)	Dunhuang / Tang dynasty, dated 676 (Shangyuan 3)	Mitsui Memorial Museum	●	●
5-19	reference	Saddharmapuṇḍarīka Sūtra in Chinese, vol.2 (translated by Kumārajīva)	Dunhuang / Tang dynasty, dated 675 (Shangyuan 2)	Mitsui Memorial Museum	●	●

## ROOM 6

6-1	39	Measured drawing of the Bamiyan caves, by KOTERA Takehisa	Japan / 1969		●	●
6-2	42	Materials related to the survey of the Bamiyan main cliff	Japan / 1970's	Kyoto University	●	●

Mitsui Memorial Museum

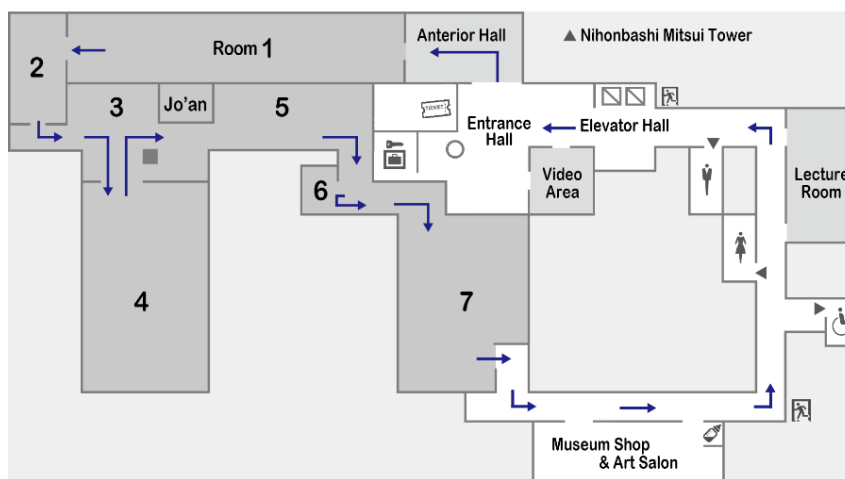

No.	Cat.	Title	Period	Owner	Display	
					9/14 ▼ 10/14	10/16 ▼ 11/12
7-1	95	Mandala of the divinities of Mii-dera ( <i>Mii Mandara</i> )	Japan / Momoyama period (16th-17th century)	Onjō-ji, Shiga	●	
7-2	94	Bodhisattva Maitreya	Japan / Kamakura period (13th century)	Kyoto National Museum		●
7-3	100	Mandala of the precincts of Kasuga Shrine and Kōfuku-ji temple	Japan / Kamakura period (14th century)	Kōfuku-ji, Nara	●	
7-4	101	Mandala of the precincts of Kasuga Shrine and Kōfuku-ji temple	Japan / Kamakura period (14th century)	Masaki Art Museum		●
7-5	98	Seated Cintāmaṇicakra ( <i>Nyoirin Kannon</i> ) with his legs half-crossed	Japan / Late Heian period (11th century)	Shitenno-ji, Osaka	●	●
7-6	124	Seated Bodhisattva Maitreya	Japan / Nambokuchō period (14th century)	Kannon-ji, Shiga	●	●
7-7	125	Seated Bodhisattva Maitreya	Japan / Nambokuchō period (14th century)	Hōryū-ji, Nara	●	●
7-8	122	Standing Bodhisattva Maitreya	Japan / Kamakura period (13th century)		●	●
7-9	121	Standing Bodhisattva Maitreya	Japan / Kamakura period (12th-13th century)	Reigen-ji, Wakayama	●	●
7-10	reference	Standing Bodhisattva Maitreya of Tōdai-ji Chūshōin (Reproduction), by KOJIMA Hisanori	Japan / 2014		●	●
7-11	123	Seated Maitreya Buddha, by Shūben and Chōben	Japan / Nambokuchō period, dated 1340 (Ryakuō 3)	Rakuya-ji, Shiga	●	●
7-12	118	◎ Seated Maitreya Buddha	Japan / Heian period (10th century)	Hōryū-ji, Nara	●	●
7-13	119	◎ Seated Bodhisattva Maitreya	Japan / Early Heian period (9th century)	Hōryū-ji, Nara	●	●
7-14	106	Mandala of the Hossō school	Japan / Muromachi period (15th century)	Kōfuku-ji, Nara	●	
7-15	104	◎ Mandala of the Hossō school	Japan / Kamakura period (13th-14th century)	Nezu Art Museum		●
7-16	107	Mandala of the Vijñaptimātratā	Japan / Muromachi-Momoyama period (16th century)	Hōryū-ji, Nara	●	
7-17	105	Mandala of the Hossō school	Japan / Nambokuchō period (14th century)	Hōryū-ji, Nara		●
7-18	109	Bodhisattva Maitreya	Japan / Nambokuchō period (14th century)	Hōryū-ji, Nara	●	
7-19	108	Mandala of the Hossō school	Japan / Muromachi-Momoyama period (16th century)	Yakushi-ji, Nara		●
7-20	113	Mandala of the Maitreya in Esoteric Buddhism	Japan / Nambokuchō-Muromachi period (14th-15th century)	Tōritenjō-ji, Hyogo	●	
7-21	111	◎ Mandala of the Maitreya in Esoteric Buddhism	Japan / Kamakura period (13th century)	Reiun-ji, Tokyo		●
7-22	129	Wellcoming descent of Bodhisattva Maitreya (Reproduction), by UMEHARA Yukio	Japan / 1980	The University Art Museum, Tokyo University of the Arts	●	
7-23	128	◎ Wellcoming descent of Bodhisattva Maitreya	Japan / Kamakura period (13th century)	The University Art Museum, Tokyo University of the Arts		●
7-24	132	Wellcoming descent of Amitābha triad and Maitreya Buddha	Japan / Nambokuchō period (14th century)	Seigan-ji, Kyoto	●	
7-25	134	Mandala of Tuṣita Heaven	Japan / Kamakura-Nambokuchō period (14th century)	Mitsuzō-in, Aichi		●
7-26	135	◎ Mandala of Tuṣita Heaven	Japan / Kamakura-Nambokuchō period (14th century)	Seigan-ji, Gifu	9/14~ 9/27	
7-27	138	The Pure Land of Amitābha Buddha based on the Guan wu liang shou jing ( <i>Taima Mandara</i> )	Japan / Kamakura-Nambokuchō period (14th century)	Seigan-ji, Gifu	9/28~ 10/14	
7-28	137	The Pure Land of Amitābha Buddha	Japan / Kamakura period (12th-13th century)	Nara National Museum		●
7-29	131	Bodhisattva Maitreya	Japan / Nambokuchō period (14th century)	Yūfuku-ji, Aichi		●

COMING UP NEXT

**Japan's Fascination with Chinese Painting and Calligraphy,  
and the National Treasure *Pine Trees in the Snow***

**November 23, 2024 - January 19, 2025**